

CROWN SEAL "CP"

(Retrofits Narrow Base T-Seal And No Backup AS-568 O-ring Groove)

PART NUMBERING SYSTEM

CP

-

334

-

SC

AN

Uniform AS-568 O-ring Dash Number

Cap Material

SC = Standard Urethane
TC = Hi-Performance Urethane
RH = Fluorotrel

Expander Material

AN = Standard Service Nitrile
BN = Low Temp Nitrile
EP = EPR
AV = Fluorocarbon

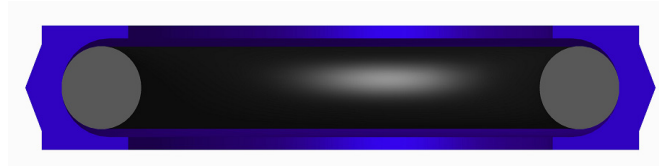

GLAND DIMENSIONS

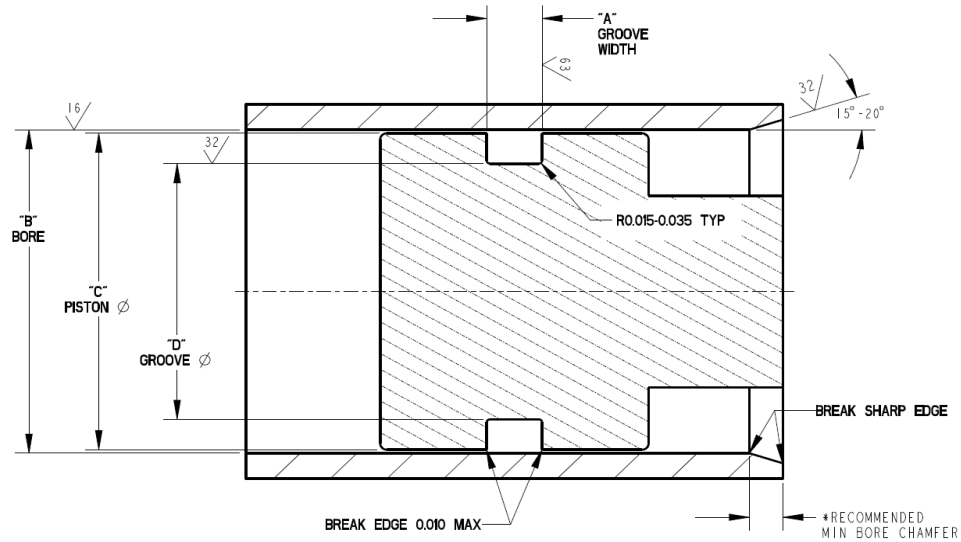

"B" Bore Ø	ØB Tolerance Range	"D" Groove Ø	ØD Tolerance Range	CP Series	"A" Groove Width +0.010"/-0.000"	E1** Maximum Diametral Clearance		*Recommended Min Bore Chamfer
						Without Wear Rings	With Wear Rings	
0.375-0.550	+0.002/-0.000	ØB - 0.187	+0.000/-0.002	1	0.150	0.004	0.020	0.125
0.561-1.750	+0.002/-0.000	ØB - 0.246	+0.000/-0.002	2	0.185	0.004	0.022	0.125
1.875-5.000	+0.003/-0.000	ØB - 0.374	+0.000/-0.003	3	0.280	0.006	0.024	0.156
>5.000	+0.005/-0.000	ØB - 0.480	+0.000/-0.005	4	0.366	0.006	0.025	0.187

**The CP crown seal can generally be used to 5000 psi when using the E1 gap dimension. The CP crown seal can generally be used to 3000 psi when using the E2 gap dimension.

Pressure ratings are for general seal selection guidance at 150°F. Customers should always test seal components for their specific applications.

Note:
Not all sizes listed are tooled.
Please contact HPS for availability and custom sizes.

CROWN SEAL WIDE BASE "CPW"
(Retrofits Cap-T And Intermediate or Wide Base T-Seal Groove)

PART NUMBERING SYSTEM

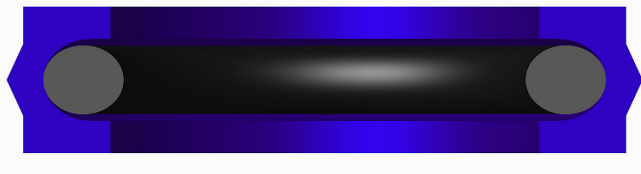
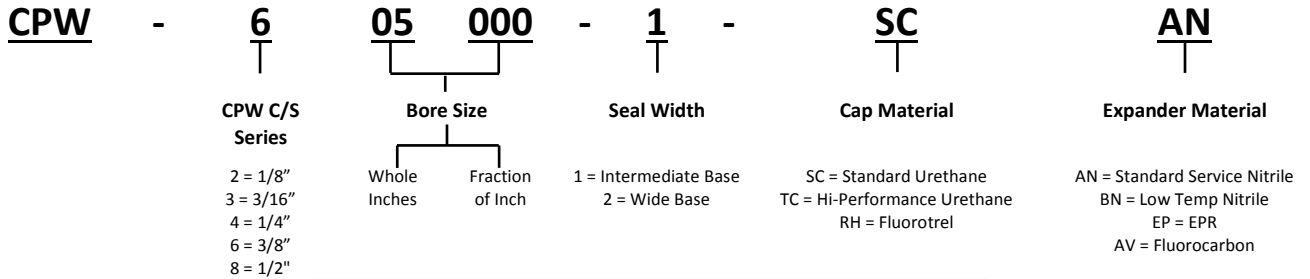

GLAND DIMENSIONS

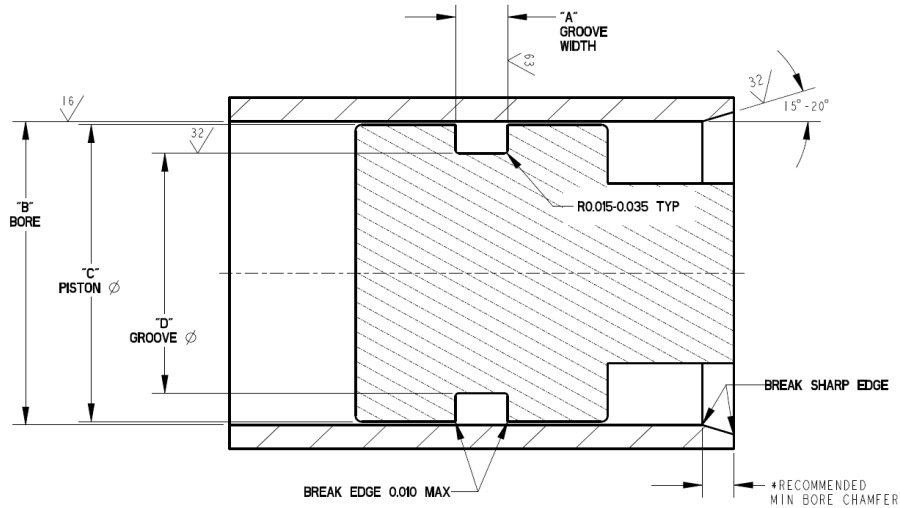

"B" Bore Ø	ØB Tolerance Range	"D" Groove Ø	ØD Tolerance Range	CPW C/S Series	"A" Groove Width +0.010"/-0.000"		E1** Maximum Diametral Clearance		*Recommended Min Bore Chamfer
					Inter.	Wide	Without Wear Rings	With Wear Rings	
1.000-1.750	+0.002/-0.000	ØB - 0.242	+0.000/-0.002	2	0.235	0.304	0.004	0.022	0.125
1.875-4.875	+0.002/-0.000	ØB - 0.374	+0.000/-0.002	3	0.334	0.424	0.006	0.024	0.156
3.000-16.000	+0.004/-0.000	ØB - 0.480	+0.000/-0.003	4	0.475	0.579	0.006	0.025	0.187
5.000-16.000	+0.005/-0.000	ØB - 0.730	+0.000/-0.004	6	N/A	0.750	0.008	0.028	0.250
16.125-22.000	+0.005/-0.000	ØB - 0.940	+0.000/-0.005	8	N/A	0.750	0.008	0.030	0.295

**The CPW crown seal can generally be used to 5000 psi when using the E1 gap dimension. The CPW crown seal can generally be used to 3000 psi when using the E2 gap dimension.

Pressure ratings are for general seal selection guidance at 150°F. Customers should always test seal components for their specific applications.

Note:
 Not all sizes listed are tooled.
 Please contact HPS for availability and custom sizes.

CROWN SEAL W/ BACKUPS "CPB"
(Retrofits Cap-T And Intermediate or Wide Base T-Seal Groove)

PART NUMBERING SYSTEM

<u>CPB</u> -	<u>6</u>	<u>05</u> <u>000</u>	-	<u>1</u>	-	<u>SC</u>	<u>AN</u>	<u>AD</u>
		┌───┴───┐						
	CPB C/S Series	Bore Size		Seal Width		Cap Material	Expander Material	Backup Material
	2 = 1/8" 3 = 3/16" 4 = 1/4" 6 = 3/8" 8 = 1/2"	Whole Inches Fraction of Inch		1 = Intermediate Base 2 = Wide Base		SC = Standard Urethane TC = Hi-Performance Urethane RH = Fluorotrel	AN = Standard Service Nitrile BN = Low Temp Nitrile EP = EPR AV = Fluorocarbon	AD = MoS ₂ Polyamide

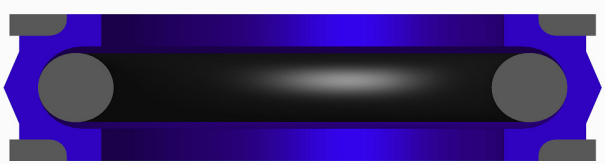

GLAND DIMENSIONS

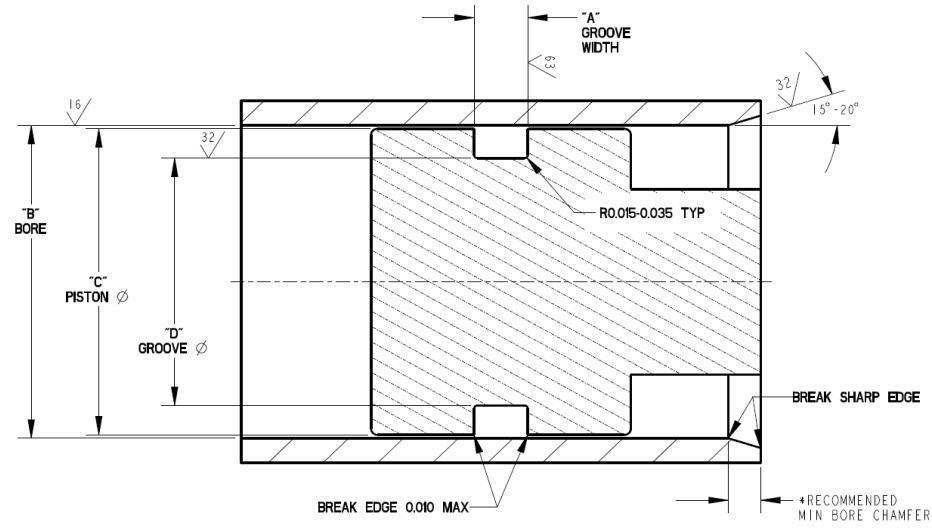

"B" Bore Ø	ØB Tolerance Range	"D" Groove Ø	ØD Tolerance Range	CPB C/S Series	"A" Groove Width +0.010"/-0.000"		E1** Maximum Diametral Clearance		*Recommended Min Bore Chamfer
					Inter.	Wide	Without Wear Rings	With Wear Rings	
1.000-1.750	+0.002/-0.000	ØB - 0.242	+0.000/-0.002	2	0.235	0.304	0.004	0.022	0.125
1.875-4.875	+0.002/-0.000	ØB - 0.374	+0.000/-0.002	3	0.334	0.424	0.006	0.030	0.156
3.000-16.000	+0.004/-0.000	ØB - 0.480	+0.000/-0.003	4	0.475	0.579	0.008	0.030	0.187
5.000-16.000	+0.005/-0.000	ØB - 0.730	+0.000/-0.004	6	N/A	0.750	0.010	0.035	0.250
16.125-22.000	+0.005/-0.000	ØB - 0.940	+0.000/-0.005	8	N/A	0.750	0.010	0.035	0.295

**The CPB crown seal can generally be used to 6000 psi when using the E1 gap dimension. The CPB crown seal can generally be used to 4500 psi when using the E2 gap dimension.
 Pressure ratings are for general seal selection guidance at 150°F. Customers should always test seal components for their specific applications.

Note:
 Not all sizes listed are tooled.
 Please contact HPS for availability and custom sizes.



CROWN SEAL (THERMOPLASTIC) CAP MATERIALS				
Service	Temp. Range	HPS Compound	Durometer	Base Polymer
Gen. purpose hydraulic oils MIL-H-5606 oils Petroleum based lube oils	-65/+220°F	SC RC	95A 55D	Polyurethane
Gen. purpose hydraulic oils MIL-H-5606 oils High performance	-65/+240°F	TC	95A	Polyurethane
Same as above MIL-L-23699 MIL-L-7808 Pydraul '30E, '50E, 115E Petroleum lube oils Water glycol Phosphate ester emulsions Gasoline (leaded & un-leaded) Kerosene Brake Fluid	-65/+275°F	RH	55D	Thermoplastic Elastomer

CROWN SEAL ENERGIZER MATERIALS				
Service	Temp. Range	HPS Compound	Durometer	Base Polymer
Gen. purpose hydraulic oils Petroleum based lube oils Water-Glycol ATF and soluble oils	-40/+250°F	AN	70A	"NBR" Nitrile
MIL-H-5608 Fluid MIL-H-6083 Fluid	-65/+275°F	BN	70A	"NBR" Nitrile
Gasoline Kerosene	-65/+160°F			
Phosphate ester emulsions	-65/+250°F	EP	70A	"EPR" Ethylene/Propylene
Unleaded gasoline Pydraul '30E, '50E, '90E, 115E	-20/+400°F	AV	75A	"FKM" Fluorocarbon

Note:
Not all sizes listed are tooled.
Please contact HPS for availability and custom sizes.